

50-S-51 - SPEEDLINE System Data Sheet - Version V1 (24-10-23)

SPEEDLINE 50mm 'C' Stud Partition @600mm Ctrs,
 with Siniat GTEC 12.5mm Standard Board each
 side

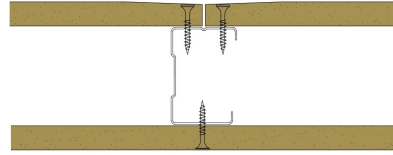

System Performance Breakdown

Fire Resistance:

BS476 Part 22:1987:

Test Ref & Date or Applied Ref & Report:

Max Height:

Thickness:

Duty Grade: BS 5234: Part 2:1992:

Sound Insulation:

NA/NA Minutes (Integrity/Insulation).

- **BRE Report P102396-1011C**

Refer to Speedline Specification Clause

77 mm. (At Base Track, Excluding Finishes)

Medium - Annexes A-F

NA R_wdB, Date Tested or Assessed Against -

TESTED AT ONE OF THE UKAS
 ACCREDITED LABORATORIES
 BELOW

B.T.C
 (H-Ref on Graph)



B.R.E



AIRO



S.R.L

